

# ANDRO M

surface fixed

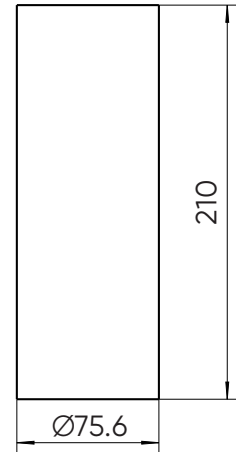

## TECHNICAL DETAILS

Light source	<b>Tridonic LED</b>
Colour temp	<b>2700 K / 3000 K / 4000K</b>
Mounting	<b>Fixed surface</b>
Ballast	<b>Integral</b>
Dimensions	<b>Ø75.6 mm x 210 mm</b>
Voltage	<b>240V</b>
Power	<b>25 w</b>
CRI	<b>90</b>
Lumen output	<b>2000 lm</b>
Beam angle	<b>20° / 33° / 42° / 53°</b>
Accessories	<b>Honeycomb, Louvre</b>
Mean lifespan	<b>50,000 hrs</b>
Dimming options	<b>1-10V, Triac, DALI</b>
Driver/control manufacturer	<b>HEP</b>
Trim colour	<b>Black, White</b>
System efficacy	<b>&gt;80lm/W</b>
Light output ratio	<b>85%</b>
Forward Current	<b>600mA</b>
IP Rating	<b>IP20/IP65</b>